

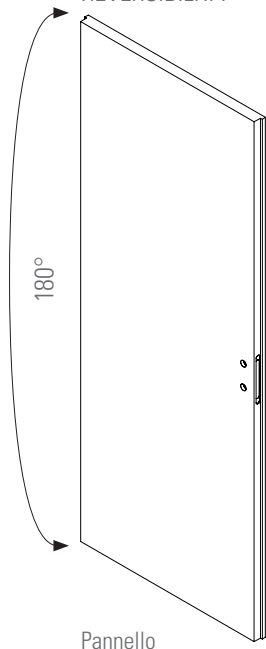

FACILE REVERSIBILITÀ

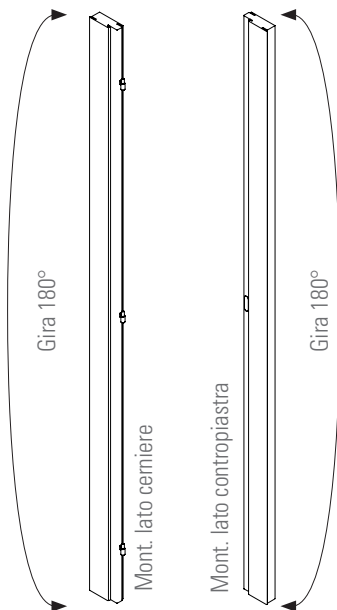

Traverso

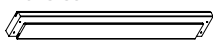

Pannello

/ BOX CONFEZIONE

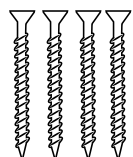

n°4 viti 4,5x60 mm



n°2 viti 3,5x20 mm



n°3 Rondelle

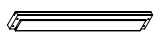

n°1 Traverso

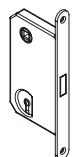

n°1 Serratura
Polaris magnetica

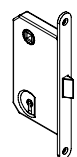

n°1 Serratura
Evolution mec.



n°1 Incontro
+ vaschetta mag.



n°1 Contropiastra
meccanica

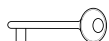

n°1 Chiave



n°1 Scrocco
(Per Evolution)

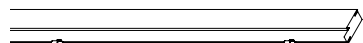

n°1 Montante lato cerniere

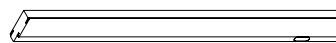

n°1 Mont. lato contropiastra

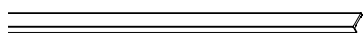

n°2,5 Coprifili lato interno da 80 mm

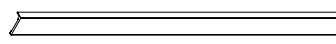

n°2,5 Coprifili lato esterno da 80 mm



EFFEBIQUATTRO Spa
Viale Edison 47
20831 Seregno (MB)
Tel. +39 0362.277.1
Fax +39 0362.277.777
info@effebiquattro.it
www.effebiquattro.it



facile

FACILE ISTRUZIONI DI MONTAGGIO

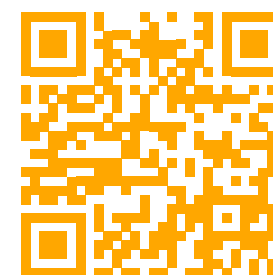

EFFEBIQUATTRO *Milano*

www.effebiquattro.it



/1
Assemblare il telaio avvitando il traverso ai montanti, ed inserirlo nel vano porta

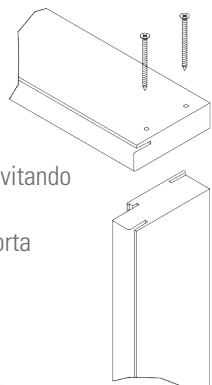

/5
Inserire nel telaio i coprifili montanti e traverso interni

/6
Tagliare l'estremità superiori delle alette dei coprifili montanti esterni ed inserirli nel telaio col coprifilo traverso

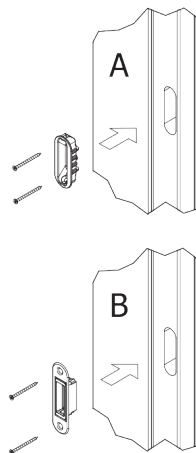
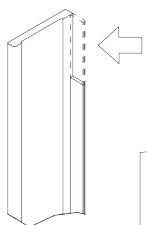

/2
Fissare la contropiastra meccanica (A) o magnetica con incontro + vaschetta (B) nell'apposita sede sul montante

/4
Tagliare spigoli montanti lato esterno

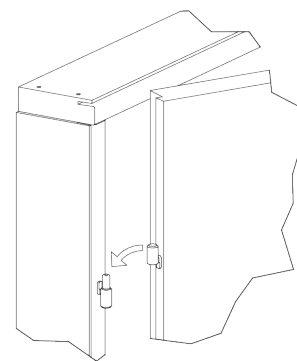

/3
Montare l'anta sul montante

/ LA PORTA VIENE FORNITA CON PREDISPOSIZIONE DI APERTURA A SPINGERE DESTRA, PER OTTENERE APERTURA SPINGERE A SINISTRA SEGUIRE LE ISTRUZIONI:

/1
RUOTARE LE CERNIERE SUL MONTANTE

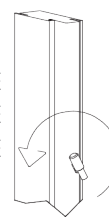

/2
RUOTARE LE CERNIERE SULL'ANTA

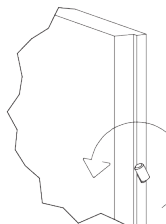

/3
SVITARE ED ESTRARRE LA SERRATURA, RUOTARLA E RIAVVITARLA

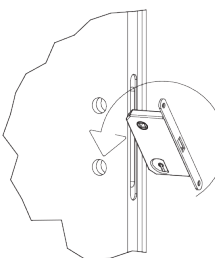

/4
INSERIRE SCROCCO SERRATURA (nel caso sia presente la contropiastra meccanica)

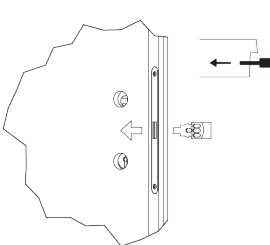

facile